

www.kinetic.co.th



ISO 9001



ISO 14001

WSSR SERIES

1500~15000 Liter/min



WOOSUNG VACUUM CO. LTD.

WSSR SERIES

1500~15000 Liter/min



DESIGN & OPERATING PRINCIPLES

WSSR 펌프의 구조는 그림(a)와 같이 실린더내에 편심되어 있는 로터와 피스톤, 슬라이드핀, 배기밸브 및 앞,뒤커버 그 외 다수의 부품으로 구성된다.

동작원리는 그림(b)와 같이 로터가 회전하면 흡입구를 통해 실린더내로 기체가 흡입된다. 그림(b)-④를 지나면서 압축되기 시작한다. 완전히 압축되면 (8580 Torr 이상이 되면) 배기밸브를 통하여 배출된다.

The design of WSSR PUMP is as like Figure(a), there are composed of the rotor made as eccentric shape, the slide pin, the exhaust valve and the front/rear cover. When the rotor rolls, the air is inhaled into the cylinder through the Inlet port. And this process continues until Figure(b)-④ and the air is started compressing as passing the state of Figure(b)-④. After compressing completely (about over 850 Torr), the compressed air is extruded through the exhaustion valve.

SIMPLIFIED PUMP STRUCTURE SKETCH

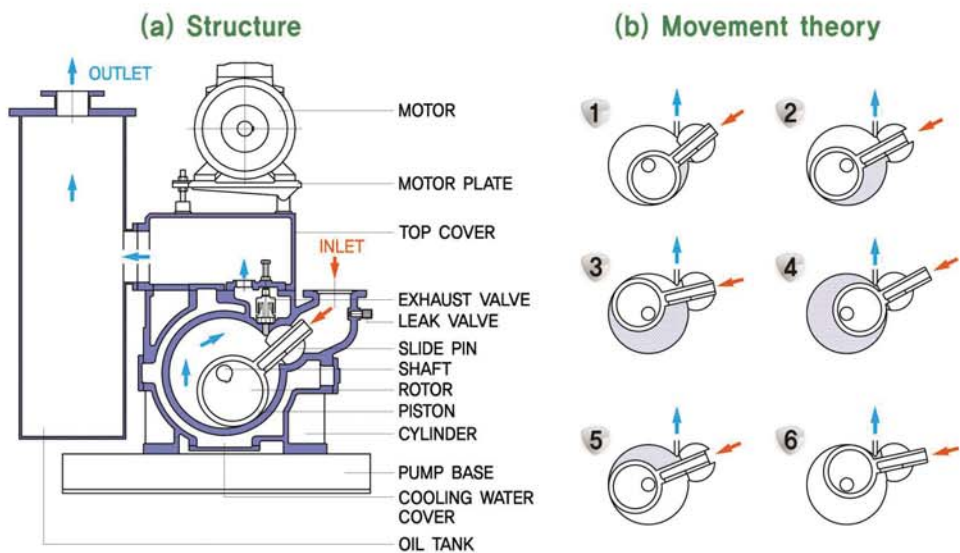

DESIGN FEATURES

1. 우수한 진공도 및 배기속도.
2. 국제규격에 따른 흡배기구 사용.
3. 구조가 간단하며 내구성이 큼니다.
4. 지속적인 출고, 제품관리로 A/S를 받을 수 있습니다.
1. Excellent ultimate vacuum and pumping speed.
2. International standard flange.
3. Simple structure and High durability
4. Vacuum solutions that support the customer's needs.

WSSR SERIES

1500~15000 Liter/min



TECHNICAL DATA

DESCRIPTION	UNIT	WSSR-1.5K	WSSR-2.5K	WSSR-4.5K	WSSR-7.5K	WSSR-15K
Displacement speed	L/min	1500	2500	4500	7500	15000
Ultimate pressure	Torr	5×10^{-3}	5×10^{-3}	5×10^{-3}	5×10^{-3}	5×10^{-3}
Inlet port		VG50	VG80	VG80	VG100	VG150
Outlet port		VF50	VF65	VF80	VF100	VG125
Motor power	kW	2.2	3.7	7.5	11	22
Rotational speed of pump	R.P.M	400	440	420	380	370
Oil filling	Liter	12	20	25	50	55
Weight(including motor)	Kg	265(297)	342(380)	444(518)	742(849)	1064(1245)
V-Belt	Size/Q'ty	B-68 / 3	B-71 / 3	B-87 / 3	C-103 / 4	C-121 / 6

PUMPING SPEED CURVE

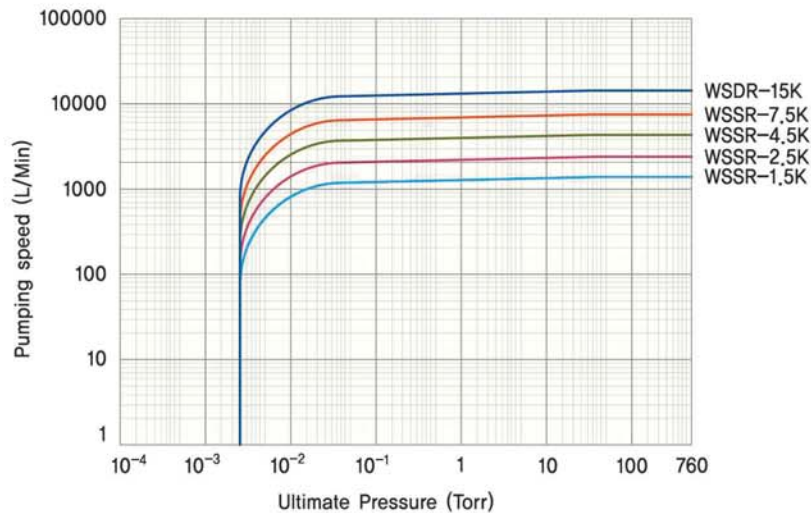

※ 주의사항

모든 부품이나 진공오일은 순정품이나 제조자가 추천한 제품을 사용하기 바라며, 만약 불량품을 사용하여 발생한 고장에 대해서는 책임을 지지 않습니다.

※ Attention

All spare parts and vacuum oil should be used genuine ones or suitable recommended by manufacturer. If any troubles from customers used defective parts, we don't have a responsibility.

WSSR SERIES

1500~15000 Liter/min



OUTSIDE DIMENSION

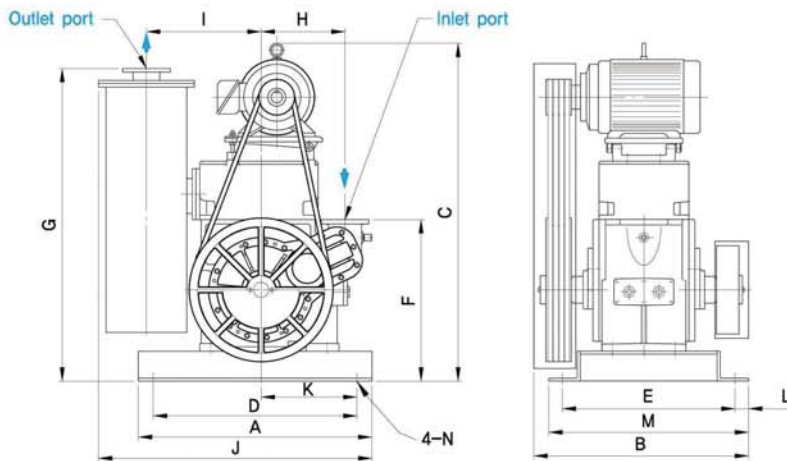

(UNIT : mm)

MODEL	A	B	C	D	E	F	G	H	I	J	K	L	M	N
WSSR-1,5K	700	545	963	625	440	422	875	265	332	782	303	35	510	Ø13
WSSR-2,5K	740	694	969	665	575	420	873	270	361	846	328	38	650	Ø16
WSSR-4,5K	780	717	1114	680	545	515	1020	280	383	888	320	45	635	Ø20
WSSR-7,5K	1000	844	1353	870	635	640	1280	363	480	1120	400	63	760	Ø20
WSDR-15K	1305	1237	1453	1175	970	814	1340	388	629	1474	425	75	1120	Ø20

DIMENSIONS of FLANGE

(UNIT : mm)

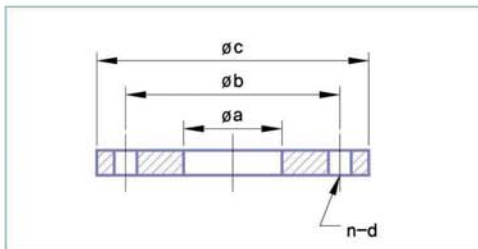

Standard	a	b	c	n	d
VG50/VF50	50	100	120	4	M8
VF65	65	120	145	4	M10
VG80/VF80	80	135	160	4	M10
VG100/VF100	100	160	185	8	M10
VG125	125	185	210	8	M10
VG150	150	210	235	8	M10

WVF (주) 우성진공
WOOSUNG VACUUM CO LTD

Representative Office:-
KINETIC ENGINEERING CO., LTD.
2, Soi Pracha-U-Thit 56, Pracha-U-Thit Rd.,
Tungkru, Tungkru, Bangkok Thailand 10140
Tel: +662 873 5550 (Auto) Fax: +662 873 5552
E-mail: sales@kinetic.co.th <http://www.kinetic.co.th>